

Planning Guide Cooktops

Contact Us

For any scheduling or delivery concerns, please call **704-391-6031** or email us at delivery@queencityonline.com.

Measuring your space before purchasing an appliance is crucial to ensure a perfect fit and avoid installation complications. It enables proper planning, prevents damage, and guarantees that the appliance aligns with both functional and aesthetic requirements.

Use this checklist as a guide to measuring your area.

If replacing, what is the current brand and year of your cooktop? _____

Have you been happy with it's performance? Yes ____ No ____

Measure the depth of the hole in the countertop on the right and left sides.

Depth right _____ inches

Depth left _____ inches

Measure the width of the hole in the countertop in the front and back.

Depth right _____ inches

Depth left _____ inches

Is there a separate downdraft unit?

If yes, please see the back page for dimensions.

Yes ____ No ____

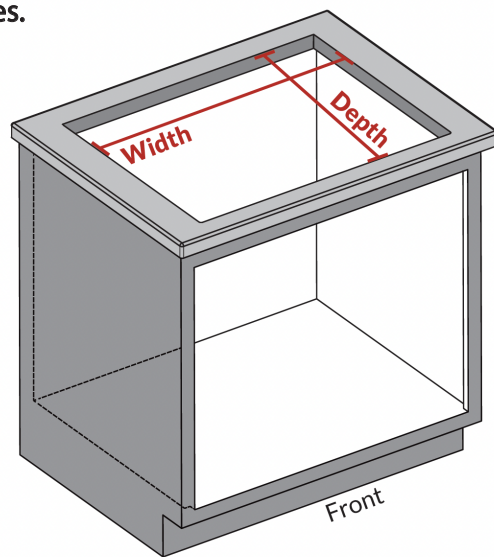

What is the distance from the underside of the countertop to the top of the nearest object like a drawer or shelf?

Distance _____ inches

Are there drawers or a wall oven underneath the cooktop?

None ____ Drawers ____ Wall oven ____

Other _____

Do you have hard surface countertops or formica?

Hard surface ____ Formica ____

For gas cooktops, is there an accessible 3-prong outlet?

Yes ____ No ____

If changing to induction, do you have a qualifying amp 220v outlet?

Yes ____ No ____

If you have a gas cooktop, is the gas line black steel, copper or corrugated stainless steel with an accessible shutoff valve and up to code?

We may not be able to install your cooktop if the gas pipe or shutoff valve is not up to code.

Yes ____ No ____



Take pictures of your current cooktop and the space where it will be installed including the front side of the cabinet. If possible, please take a photo of the inside of the cabinets under the cooktop.

Specialty Cooktops

There are additional measurements needed if your current cooktop is a downdraft or rangetop model.

Downdraft models:

Measure your under cabinet space for a blower below the opening. Please supply your salesperson with a picture.

Length _____ inches

Width _____ inches

Depth _____ inches

Is your vent round, rectangular, or recirculating (no external vent)?

___ Circle

___ Rectangle

___ Recirculating

Rangetop models:

Measure the height of the cabinet area where the rangetop is located.

Height _____ inches

Is there island trim?

Yes ___ No ___

Is there a backsplash?

Yes ___ No ___

Is there a backsplash with a high shelf?

Yes ___ No ___



Arrival of your new cooktop

Our delivery teams want to ensure that you have a seamless delivery experience.

- Our delivery crews are insured and qualified.
- You will receive a call and text the day before your expected delivery to confirm the appointment window.
- You will receive a call letting you know that you are the next stop.
- Your new cooktop will be connected and tested prior to departure.

Terms & Conditions: Returns and cancellations are subject to a restocking fee. Special Order Items cannot be returned or exchanged. All pickups and deliveries are subject to our open and inspection policies to ensure damage-free product is given to our customers. Home Appliances, Electronics, Mattresses, and Furniture are non-refundable/non-returnable. If merchandise has been opened or used. Once you have accepted delivery or taken possession of the merchandise, you have 7 days to contact us regarding defects, damage, or other issues. Complete Sales Terms & Conditions can be found on our website at [QueenCityOnline.com/sale-terms](https://www.queen-city-online.com/sale-terms).