

Planning Guide Wall Ovens

Contact Us

For any scheduling or delivery concerns,
please call **704-391-6031** or email us at
delivery@queencityonline.com.

Measuring your space before purchasing an appliance is crucial to ensure a perfect fit and avoid installation complications. It enables proper planning, prevents damage, and guarantees that the appliance aligns with both functional and aesthetic requirements.

What is the current brand and year of your current wall oven? Brand _____ Year _____

Have you been happy with its performance?

Yes ____ No ____ Why or why not? _____

Use this checklist as a guide to measuring your area.

Measure the depth of the space for the oven in all four corners.

Depth top right _____ inches

Depth top left _____ inches

Depth bottom right _____ inches

Depth bottom left _____ inches

Measure the height of the space for the oven in all four corners.

Height top right _____ inches

Height top left _____ inches

Height bottom right _____ inches

Height bottom left _____ inches

Measure the width of the space for the oven in all four corners.

Width top right _____ inches

Width top left _____ inches

Width bottom right _____ inches

Width bottom left _____ inches

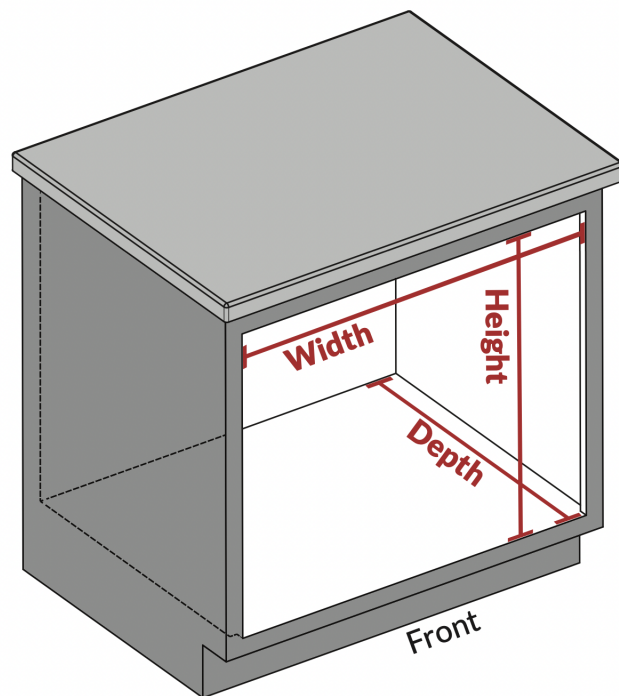

Is there room for modification of the cabinet?

Yes ____ No ____

Is your oven in a corner?

Yes ____ No ____

Is there an island in your kitchen?

If so, how far is the island from the back wall?

Yes ____ Distance _____ inches No ____



Take pictures of your current wall oven or the space it will be installed. If possible, please take a photo of the inside of the cabinets.

Getting ready for delivery

There are a few things to do before your new wall oven is delivered.

Locate your breaker panel and identify the breaker for the wall oven.

The installer needs to turn off the power to your wall oven during installation.

What is the amperage of the breaker?

_____ Amp

Is your wall oven hard wired or plugged into an outlet?

Hard wired _____ Outlet _____



If you have a gas wall oven, is the gas line black steel or copper with an accessible shutoff valve and up to code?

Yes _____ No _____

We may not be able to install your wall oven if the gas pipe or shutoff valve is not up to code.



Arrival of your new wall oven

Our delivery teams want to ensure that you have a seamless delivery experience.

- Our delivery crews are insured and qualified.
- You will receive a call and text the day before your expected delivery to confirm the appointment window.
- You will receive a call letting you know that you are the next stop.
- Your new wall oven will be connected and tested prior to departure.